

## MONA Light Bar

GB

IP20



Power  
**6 w**

Efficiency  
**58 Lm/w**

Lifetime  
**50.000 Hours**  
(70% Lumen maintenance)

Input  
**10-32 VDC**

Material  
**Plastic /  
Aluminum**

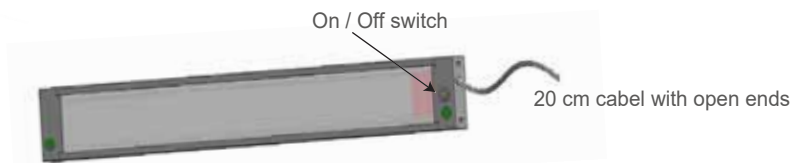
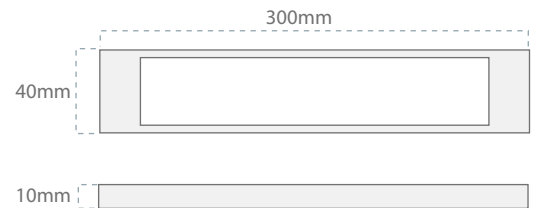

Product code	Lumen output	Beam	Power	CCT	CRI
MONA-LIGHT-BAR-6W-CW	350 lm	120°	6 w	4000 K	> 85
MONA-LIGHT-BAR-6W-WW	350 lm	120°	6 w	3000 K	> 85

### Feature

- Light bar for engine room and cabinet.
- IP20 design with integral thermal management for long life.
- High precision machining ensures perfect mechanical fit for long life.
- With finger touch On/Off switch.
- Memory function on last state:
- ON when disconnected -ON when re-connected to power.
- OFF when disconnected -OFF when re-connected to power.

### Material

- Aluminum
- Plastic (Polycarbonate)

### Benefit

- High reliability
- Maintenance free

### Application

- Marine and Autocamper light