

# Installation Instructions

**CASOLUX**<sup>®</sup>  
The lights of tomorrow

## 10W / 20W Marine LIGHTS MODEL OPERATING AND SAFETY INSTRUCTIONS

Congratulations, on your purchase of one of the most advanced LED leakproof sealed ceramic technology lights, in the world today. Your Next Generation 10W / 20W marine lights, will provide you with years of trouble free use and enjoyment. 10W / 20W is fully sealed leak-proof technology has been proven internationally for many years. Since your new 10W / 20W is consumes less power, maintenance free you need never change a globe in your Dock, Boat, Yacht and Jet Ski .

Please take a few minutes to read and observe the following installation and safety information.

10W / 20W single colour is 12V AC/DC volts

### WARNING:

1. Our Underwater LED Lights are extremely bright, please **DO NOT** look directly at the light as it may damage your eyes.
2. All 10W / 20W **MUST** switch on under the water.
3. Accessories included as below:

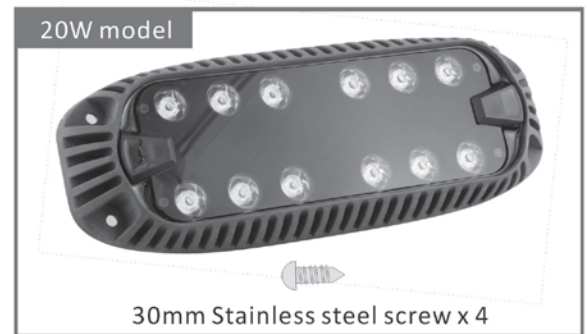

### RISK OF ELECTRICAL SHOCK OR ELECTROCUTION

This underwater lights fixture must be installed by a licensed technician or certified electrician serviceman in accordance with all applicable local codes and ordinances. Improper installation may create an electrical hazard which could result in death or serious injury to users, installers or others due to electrical shock and may also cause damage to property. **DO NOT** connect incorrect voltage or you may damage your lights and invalidate the warranty. All Marine lights **MUST** turn on under the water only.

### INSTALLATION INSTRUCTIONS

A: Preparatory steps which must be completed by the electrician before lights is installed see Figure 1:

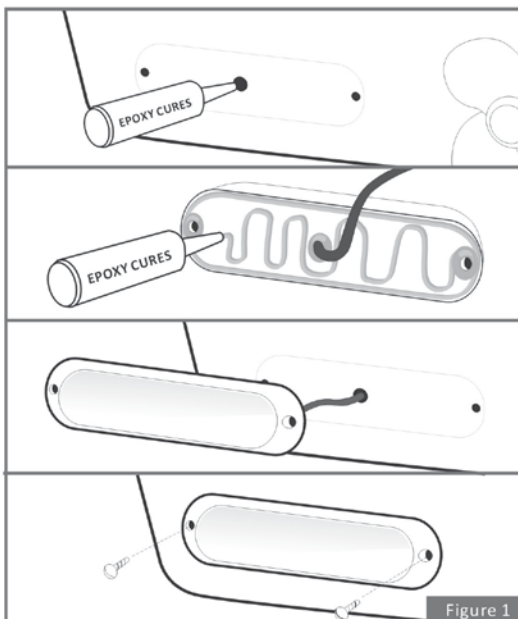

1. Installation surface **MUST** be dry and clean .
2. Select mounting location and drill a 5mm diameter hole.
3. Epoxy the inside surface of the drilled hole to insure that water will not be absorbed into the hull in case of water intrusion.
4. After the epoxy cures, insert the neck of the light through the hull. Put a generous amount of bedding sealant under the outer flange to insure a watertight seal.
5. Put a generous amount of sealant on the back of the nut and tighten.
6. A bonding screw is attached to the back plate in order for the lights to be attached to the vessel's grounding system.
7. Attach power cable to fused power source.

10W draws 1A at 12volts AC/DC power

20W draws 2A at 12volts AC/DC power

8. The Mounting location **MUST** be a flat surface. (Fig 2)

